

WINCH MOUNT INSTRUCTION
ARTIC CAT 366, 350, 425
(Roller Fairlead not included with mount kit)

ITEM	PART#	QTY.	DESCRIPTION
1	1513-1	1	Winch Mount Plate
2	1513-2	1	Fairlead Plate
3	HDW1050	2	8mm x 20mm Hex Bolt
4	HDW2050	2	5/16 x 3/4 Hex Bolt
6	HDW7058	2	5/16 Nylock Nut
7	HDW9002	4	5/16 Flat Washer

1. Remove the front plastic bumper cover.
2. Attach the main plate on top of the of the frame per illustration. Bolt the rear in place through the stock slotted holes in the frame mounts using the 5/16" x 3/4" hex bolts, washers and nylock nuts.
3. Attach the fairlead plate to the front of the bumper making sure it aligns with the fairlead holes in the main plate. Use the 8mm x 20mm hex bolts and 2 – 5/16 flat washers into the stock threaded holes in the frame.
4. Attach the fairlead with bolts provided from winch manufacturer
5. Install your winch to the winch plate per the installation instructions provided with your winch. Position the winch on the plate as close to center as possible. Make sure the winch cable pulls from the bottom of the winch drum.
7. Reattach the bumper cover using the stock mounting hardware.

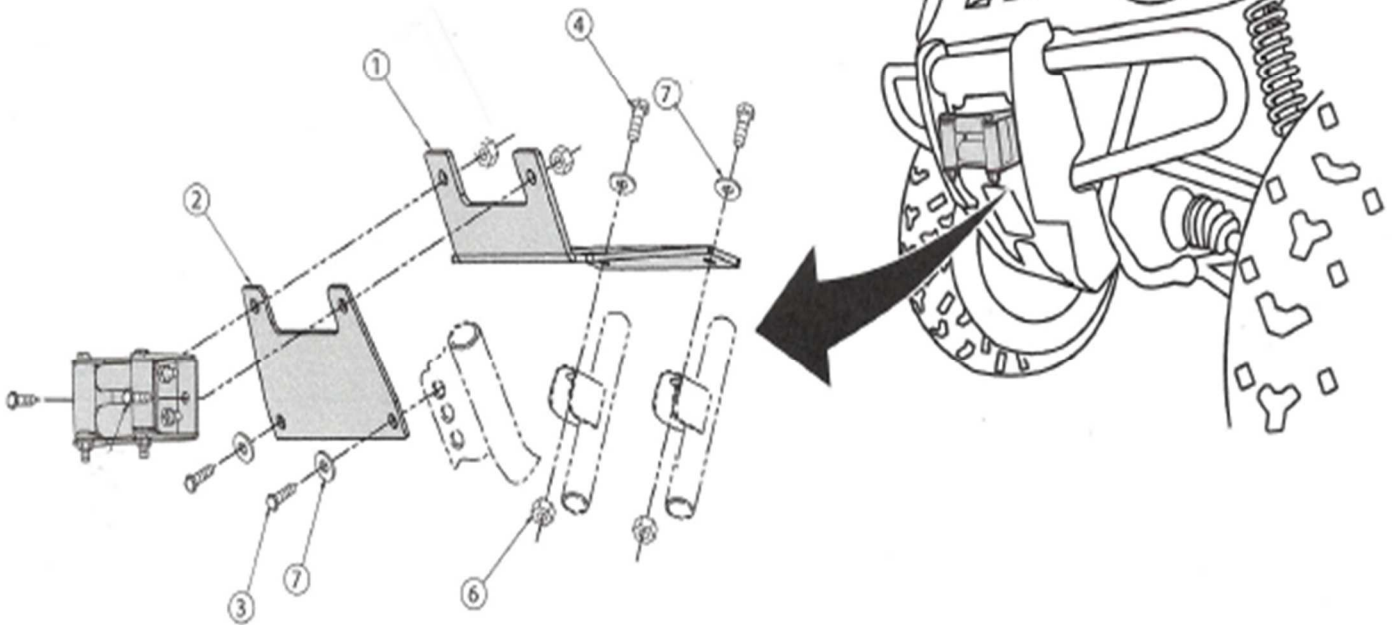

FOR QUESTIONS OR COMMENTS PLEASE CALL: 320-964-1616
 (Company Hours Monday thru Thursday 7:00 – 4:30 CST)

INST1513