

Winch Mount Installation Instructions

15-17 Honda Pioneer 500

Ref.	Qty.	Part #	Description
1	1	1619-01	Winch Mount Plate
2	1	1619-02	Roller Fairlead plate
3	2	HDW2079	5/16" x 1-1/2" x 2-3/16" Sq. U-Bolts
4	4	HDW9002	5/16" Flat Washers
5	8	HDW7058	5/16" Nylock Nuts
6	2	HDW2051	5/16" x 1" Hex Bolt
7	2	HDW2047	5/16" x 3/4" Carriage Bolt

NOTE: Roller fairlead not included with this kit!

INSTRUCTIONS:

1. Remove the steel front bumper assembly from the machine. Put the bumper on a workbench as you will be installing the winch to the inside of the bumper. The winch and mount will hang upside-down from the mounting arms on the bumper.
2. There are multiple winch bolt patterns built into this mount to accommodate most winches. The winch will be placed on the mount upside down but with the cable still coming off the bottom of the drum. Using the bolts that came with your winch, loosely bolt the winch to the bottom of the mount plate.
3. Place the winch and mount combination underneath the arms of the bumper with the fairlead bracket facing forward and down. See illustrations. Loosely bolt the front of the mount to the bottom of the bumper using two square u-bolts (#3), flat washers (#4), and nylock nuts (#5). Make sure it is loose on the bumper so you can move it forward or backward.
4. Take the bumper and winch assembly and position it back into place on the machine. Align the winch and mount so the rear holes in the mount line up with the bumper mounting bolts. Reinstall the bumper through the winch mount using the factory hardware. You can now tighten all the winch and winch mount hardware.
5. Put the roller fairlead bracket in place over the main winch mount plate and facing upwards. The winch mount and fairlead bracket have two sets of bolt holes to fit most roller fairleads or aluminum haswells. Use whichever pattern lines up with your fairlead or hawse. Loosely bolt the fairlead, fairlead bracket and winch mount plate together using the 5/16" x 1" hex bolts (#6) and nylock nuts (#5). Using the two holes in the top of the fairlead bracket as a guide, use a 3/8" drill bit and drill a hole through the bumper on each side. Bolt in place using two 5/16" x 3/4" black carriage bolts (#7) and 5/16" nylock nuts (#5).

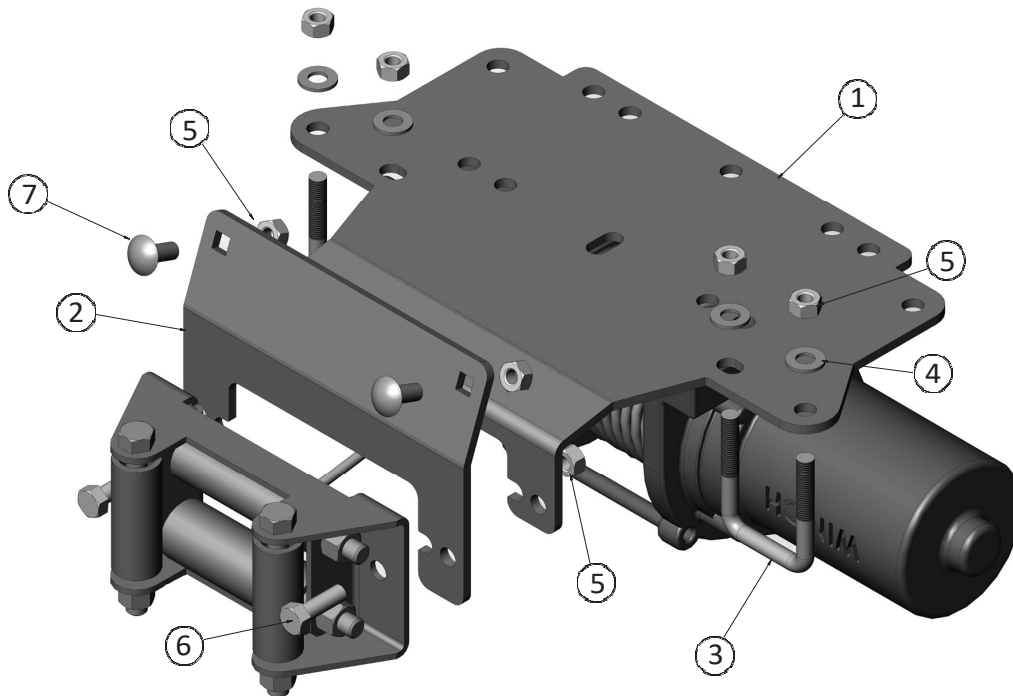

Questions or Comments please call 320-964-1616 Mon. thru Thur. 7:00 to 4:30 CST

INST1619 5/28/18