

Receiver Hitch

Suzuki

2005-14 King Quad

450,500,700,750

Part Number: 1191

Item	Qty.	Part#	Description
1	1	1191-200	Hitch Weldment
2	2	HDW2150	5/16" x 1-1/8" x 1-3/4" U-Bolt
3	1	HDW2216	1/2" x 1-1/2" Hex Bolt
4	4	HDW9002	5/16" Flat Washer
5	4	HDW7058	5/16" Nylock Nut
6	2	HDW9026	1/2" USS Flat Washer
7	1	HDW7089	1/2" Nylock Nut

Instructions:

1. Position the receiver hitch on top of the factory ball hitch and backed up against the frame tubes.
2. Slide the two u-bolts (#2) around the back of the frame tubes and out through the holes in the receiver hitch. Loosely secure with four 5/16" flat washers (#4) and 5/16" nylock nuts (#5).
3. Install the 1/2" x 1-1/2" hex bolt (#3) and 1/2" flat washer (#6) up through both the factory ball hitch and the receiver hitch. Loosely secure on top of the receiver hitch bracket with the 1/2" flat washer (#6) and nylock nut (#7).
4. Make sure the receiver hitch is aligned and sitting flat against both surfaces then tighten all the nuts/bolts.

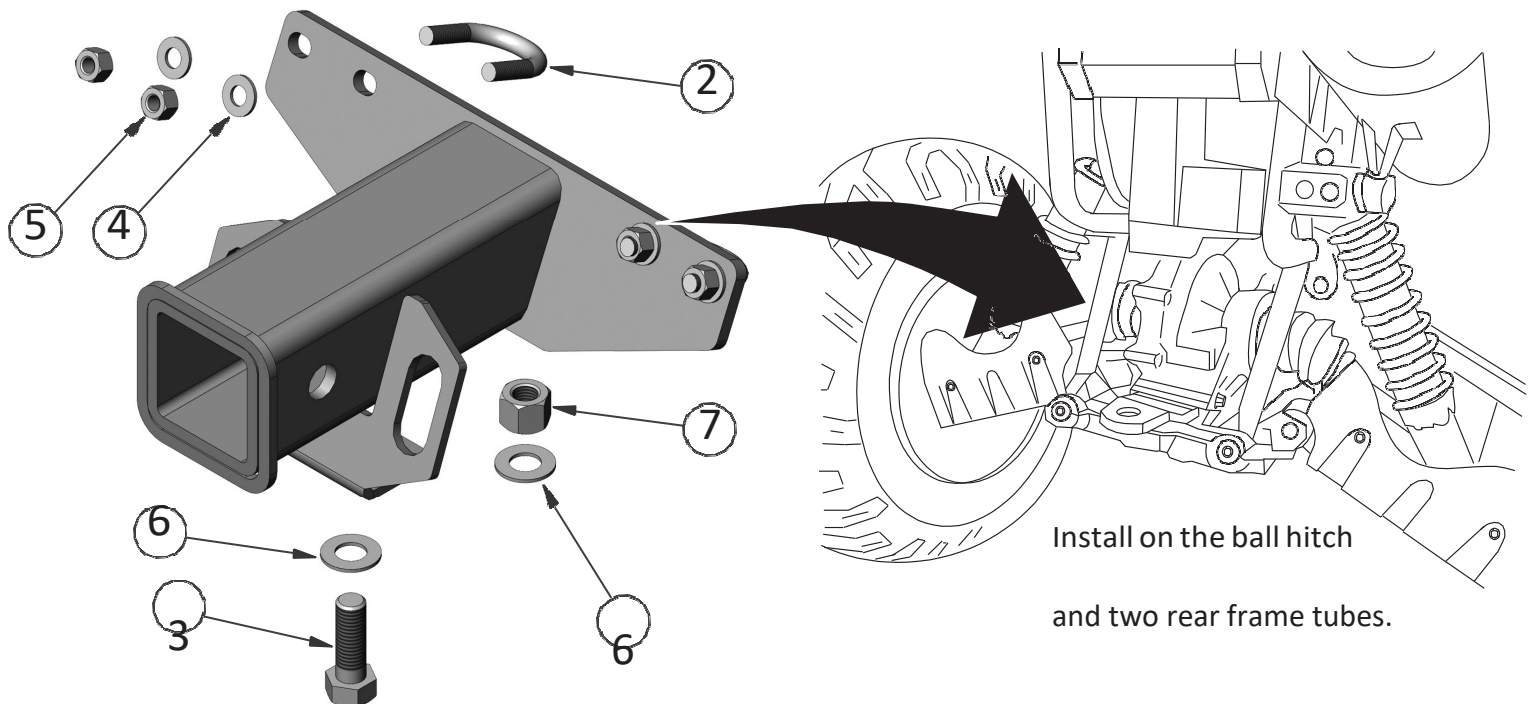

NOTE: DO NOT EXCEED THE MANUFACTURERS RECOMMENDED TONGUE WEIGHT OR TOWING CAPACITY OF YOUR ATV. THESE RATINGS CAN EITHER BE FOUND ON A DECAL ON THE REAR OF THE MACHINE OR IN YOUR OWNERS MANUAL. EXCEEDING THESE MAXIMUM WEIGHT RESTRICTIONS IS CONSIDERED ABUSE AND MAY DAMAGE YOUR HITCH, MACHINE, OR PERSON! DAMAGED HITCHES DUE TO OVERLOADING WILL NOT BE WARRANTED.