

## WINCH MOUNT INSTALLATION INSTRUCTIONS HONDA PIONEER 1000-5

PART#	QTY.	DESCRIPTION
1682	1	Winch Mount
HDW2050	2	5/16 x 3/4 Hex Bolt
HDW9002	2	5/16 Flat Washer
HDW7058	2	5/16 Nylock Nut
HDW1041	2	8mm Nylock Nut

Remove front bumper.

**NOTE:** The machine only has bolt pattern for large fairlead that has 6" bolt pattern. Winch will bolt on the bottom side of mount plate.

First remove front bumper and you will attach winch mount to front bumper. Bolt the front portion of the winch mount to the front bumper using the 5/16 x 3/4 hex Bolts, Washers and Nylock Nuts, Leave loose at this time.

Place the rear portion up in place using the bolts you removed. Place the bolt through the bumper tube frame hole and through winch mount. This will align the winch mount, now tighten the front bolts.

**NOTE:** You may also attach the winch at this point and winch will mount upside down on the bottom.

Now remove the back bolt you put in to align the winch mount and slide the bumper with winch mount back in place carefully to keep winch mount in line.

After bumper with winch mount is back in place, replace the front leg bolt going through the bumper leg and as you tighten it will go through the winch mount. Place nylock nut on bolt and tighten and repeat on other side. Back bumper bolt will just go back in place and tighten.

**NOTE:** To tighten nylock nut on forward bolt it is easiest if you use a ratchet with long extension and swivel knuckle and reach in from opposite side.

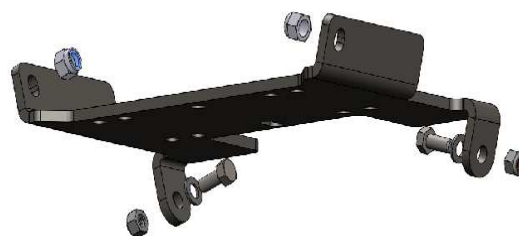

Questions or comment please call: 320-964-1616 Mon. thru  
Thur. 7:00 to 4:30 CST  
INST1682